

DRG. No. 22176

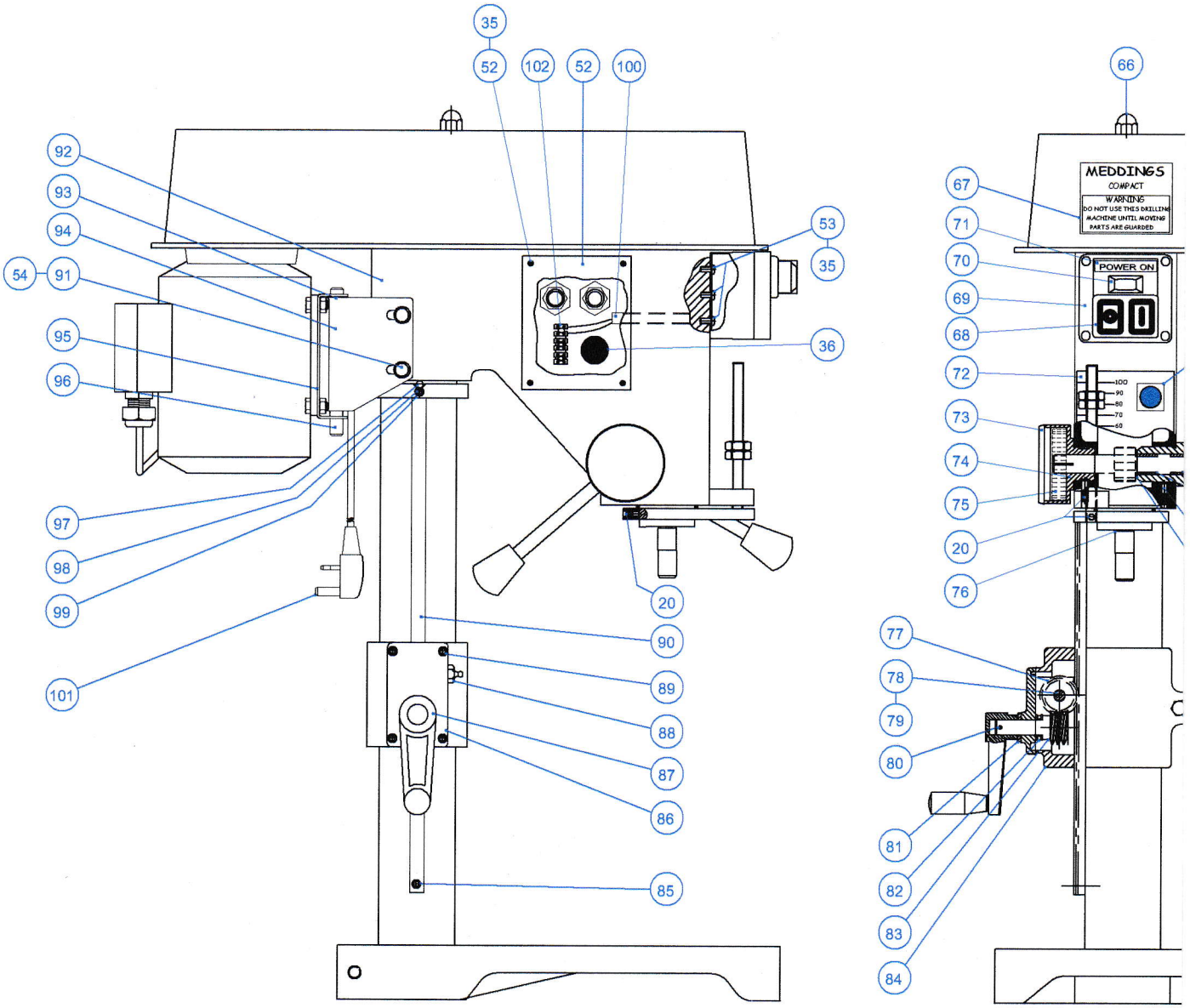

ITEM	DESCRIPTION	DRAWING No: PART No:	QTY
1	M12 x 50 HEX BOLT	10-22147	1
2	BASE	10-22146	1
3	BENCH COLUMN	10-20036	1
4	M10 x 70 HX HD BOLT	10-19128	1
5	M10 WASHER	10-18343	2
6	LOCKING BUSH	10-20016	1
7	SPINDLE SPEED LABEL	10-22179	1
8	MOTOR CABLE	10-22153	1
9	MOTOR	10-22154	1
10	COVER PLATE	10-19825/6H	1
11	GROMMET	10-20214	1
12	THREADED ADJUSTER	10-22155	1
13	M12 NUT	10-18309	6
14	M6 PLAIN HEX NUT	10-19111	4
15	M6 x 20 BOLT	10-22224	4
16	M6 WASHER	10-20128	4
17	CABLE GLAND M20	10-19397	2
18	BELT COVER	10-20006	1
19	M6 x 12 SKT SET DOW POINT	10-22156	2
20	M6 x 10 SKT GRUB SCREW	10-19121	7
21	PARALLEL KEY	10-20267	2
22	ADAPTOR SHAFT	10-22157	1
23	PULLEY	10-703	2

ITEM	DESCRIPTION	DRAWING No: PART No:	QTY
24	VEE BELT	10-7994	1
25	M4 x 10 PAN HD SCREW	10-17652	2
26	M4 SHAKEPROOF WASHER	10-21712	2
27	M4 HEX NUT	10-18435	4
28	COLUMN COVER	10-21746	1
29	2 CORE LIMIT CABLE	10-22158	1
30	BELT COVER LIMIT SWITCH	07-21829	1
31	M4 x 20 TORX BOLT	10-21830	2
32	ANGLE BRACKET	10-22159	1
33	BUSH	10-22010	1
34	SPACER TUBE	10-22160	1
35	M6 SHAKEPROOF WASHER	10-20207	11
36	BLANKING GROMMET (20 mm)	10-22254	1
37	CARRIER SLEEVE	10-20030	1
38	CINCLIP	10-808	2
39	WAVED WASHER	10-11936	1
40	CINCLIP	10-915	2
41	BALL BEARING RLS 72Z	10-7167	2
42	LOCKING COLLAR	10-805	1
43	CABLE TIE	10-22255	1
44	BALL BEARING 6203	10-70	2
45	ROD	10-22162	2
46	SCALE ROD GUIDE	10-22163	1

ITEM	DESCRIPTION	DRAWING No: PART No:	QTY
47	CAP HEAD M6 x 25	10-22256	2
48	SCALE CARRIER	10-22164	1
49	SPINDLE	10-20159	1
50	QUILL	10-20158	1
51	O RING QUILL RETURN	10-20050	1
52	COVER PLATE	10-19285	2
53	M5 x 10 PAN HD SCREW	10-18327	12
54	M8 x 16 SCREW	10-18405	2
55	3/8" BSF x 2 1/2" HEX SCREW	10-82	1
56	WAVED WASHER PLW4	10-20262	1
57	OIL LITE BUSH	10-21051	2
58	KNOB (M12)	10-21127	1
59	ST ARWHEEL RODS (M12)	10-21123	3
60	ST ARWHEEL HUB	10-20263	1
61	ACTIVATING GEAR & SHAFT	10-20021	1
62	3/16" x 1 1/2" ROLL PIN	10-10174	1
63	ACTIVATING GEAR BUSH	10-20019	1
64	PROTECT EYES LEGEND	10-21789	1
65	UNION JACK LEGEND	10-21698	1
66	M12 DOME NUT	10-22165	1
67	MIDDINGS LEGEND	10-22166	1
68	PUSH BUTTON ASSY	10-22167	1
69	SWITCH ENCLOSURE	10-22168	1

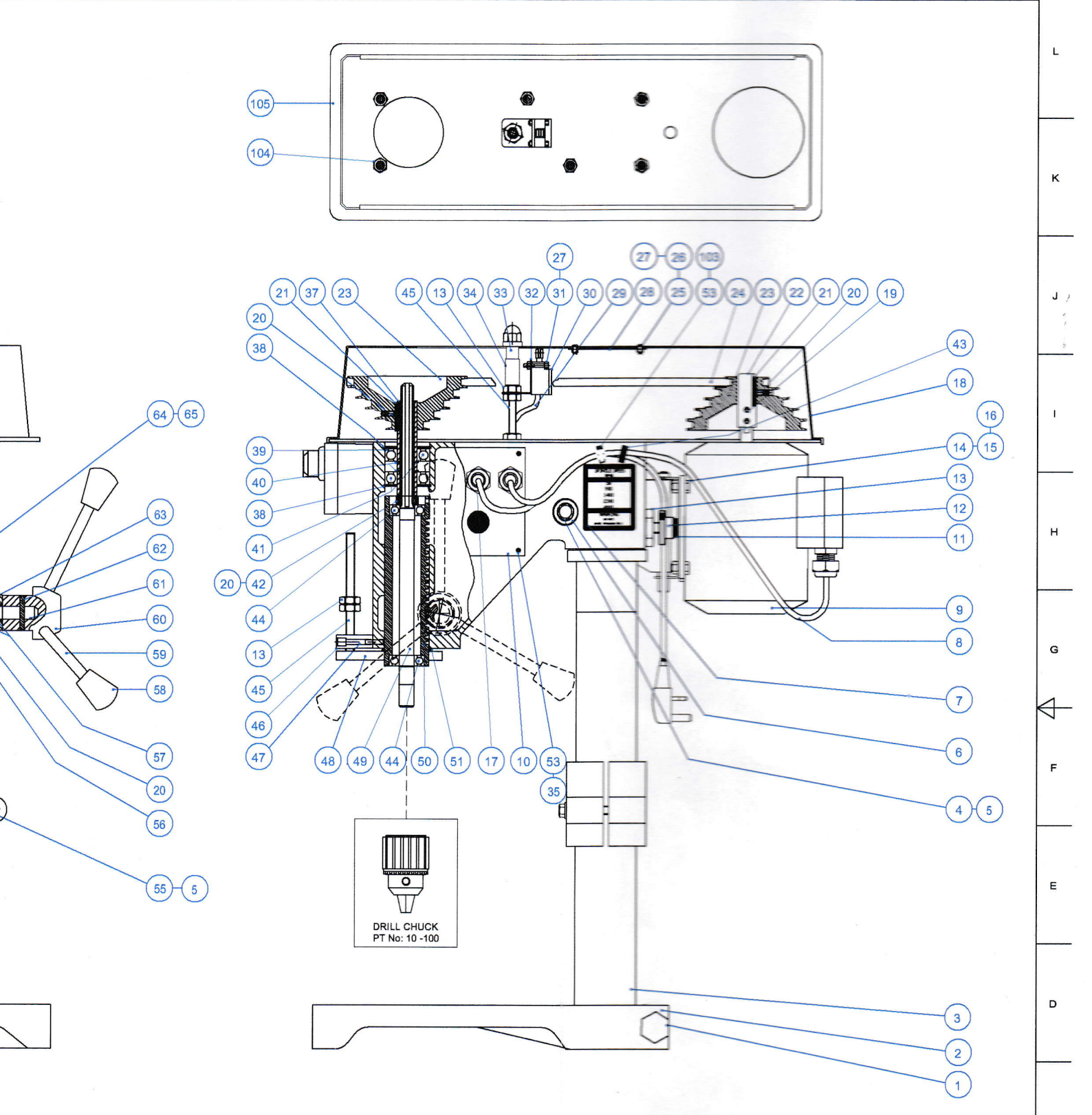

ITEM	DESCRIPTION	DRAWING No:	PART No:	QTY
70	LAMP	10-22208 (8766)		1
71	POWER ON LEGEND	10-22209		1
72	SCALE LABEL	10-22169		1
73	SPRING BOX COVER	10-19059		1
74	SPRING BOX	10-11015		1
75	RETURN SPRING	10-345		1
76	CLIP	10-13985		1
77	HELICAL PINION	10-13117		1
78	SHAFT FOR PINION	10-13118		1
79	1/4 x B5F x 3/8" SCKT SET SCREW	10-4515		1
80	4 MM x 30 MM ROLL PIN	10-9569		1
81	SPACER FOR HANDLE HRM	10-22125		1
82	THRUST BEARING	10-13127		1
83	WORM & SHAFT	10-13121		1
84	BODY FOR 2 3/4" HRM	10-13150		1
85	2 BA x 3/8" CSK SCREW	10-5469		1
86	COVER FOR 2 3/4"	10-13116		1
87	HANDLE	10-13119		1
88	1/4" BSF GREASE NIPPLE	10-337		1
89	1/4" x 5/8" CAP HD SCREW	10-916		4
90	RACK	10-13122		1
91	M8 WASHER (SPECIAL)	10-22251		2
92	HEAD	10-22172		1

ITEM	DESCRIPTION	DRAWING No:	PART No:	QTY
93	CLIP	10-20203		1
94	HINSE BRACKET	10-22171		1
95	MOTOR PLATE	10-22170		1
96	HINSE PIN	10-20010		1
97	1/4" STEEL BALL	10-1749		1
98	2 BA x 5/8" CAP HD SCREW	10-1737		1
99	RET ADJING RING	10-13956		1
100	PLASTIC SLEEVE	10-22253		1
101	13 AMP PLUG	10-22152		1
102	TERMINAL BLOCK	10-20734		1
103	PLASTIC P CLIP	10-22173		1
104	M6 x 16 HEX HD BOLT	10-20128		6
105	HEAD TOP PLATE	10-20007		1
106				

MOTOR OPTION		
DESCRIPTION	PART No:	QTY
250w MOTOR (PRODUCTION USE)	10-19861	1
MOTOR ADAPTOR PLATE	10-22245	1
VEE BELT XP2 1112 HTX	10-22246	1
ADAPTOR SHAFT FOR 10-19861	10-22247	1
M8 FULL NUT	10-18318	4
M8 x 20 UN6 HEX HD SCREW	10-20752	4
M8 WASHER	10-18319	4

ITEMS NOT DRAWN
 WINDING SCHEMATIC 10-22077
 CHUCK GUARD 10-22028

DIM'S TO 2 DEC PLACES +/- 0.0025 MM		A0
DIM'S TO 1 DEC PLACE +/- 0.25 MM		
WHOLE NUMBER DIMS +/- 0.5 MM		
TREATMENT		
SCALE 1:2 @ A0	DATE 03.03.08	DRAWN A.B
ISSUE		
TITLE		
COMPACT GENERAL ASSY		
DRG. No. 10-22176		